

2/16/2017 4:53:05 PM - P:\088121\31-08512-13100\CAD\SH-9\TRAFFIC CONTROL-P4.DWG - RODRIGUEZ, AMY

OKLAHOMA DEPARTMENT OF TRANSPORTATION				
FED. ROAD DIST. NO.	STATE	STATE JOB NO.	FISCAL YEAR	SHEET NO. / TOTAL SHEETS
	OKLA	29289(04)		41 /
DESCRIPTION		REVISIONS		DATE

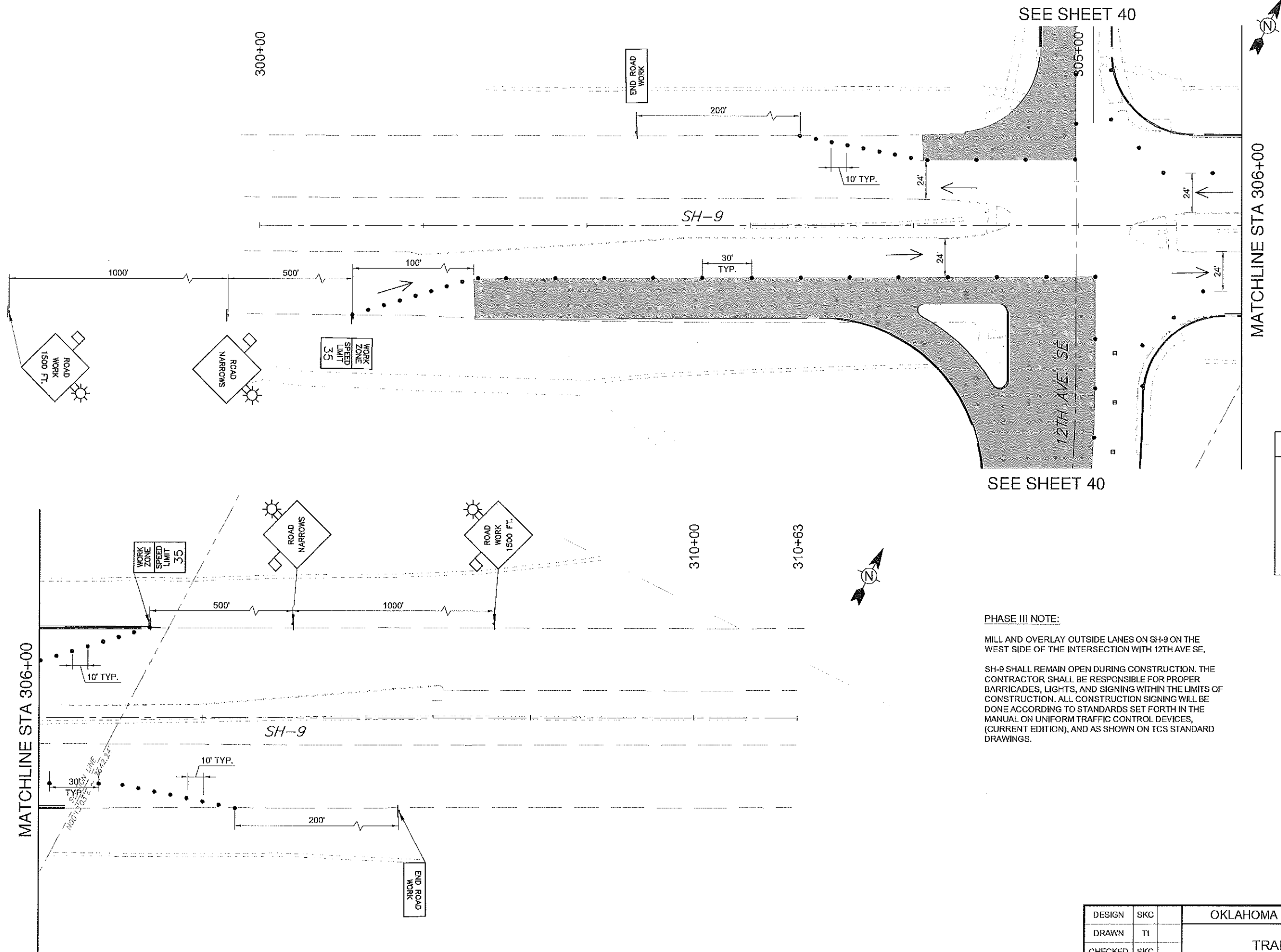

LEGEND	
	WORK AREA
	SIGN
	DRUM
	PAVEMENT MARKER (YELLOW)

**PHASE III NOTE:**  
 MILL AND OVERLAY OUTSIDE LANES ON SH-9 ON THE WEST SIDE OF THE INTERSECTION WITH 12TH AVE SE.  
  
 SH-9 SHALL REMAIN OPEN DURING CONSTRUCTION. THE CONTRACTOR SHALL BE RESPONSIBLE FOR PROPER BARRICADES, LIGHTS, AND SIGNING WITHIN THE LIMITS OF CONSTRUCTION. ALL CONSTRUCTION SIGNING WILL BE DONE ACCORDING TO STANDARDS SET FORTH IN THE MANUAL ON UNIFORM TRAFFIC CONTROL DEVICES, (CURRENT EDITION), AND AS SHOWN ON TCS STANDARD DRAWINGS.

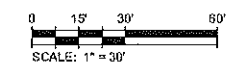

OKLAHOMA DEPARTMENT OF TRANSPORTATION			
DESIGN	SKC	TRAFFIC CONTROL - PHASE IV	
DRAWN	TI		
CHECKED	SKC		
APPROVED	MNR		
SQUAD	TI		
STATE JOB NO. 29289(04)		SHEET NO. 41	

CLEVELAND COUNTY